

DRAWING MUST BE VIEWED IN ADOBE ACROBAT TO ENABLE CUSTOM LAYERING

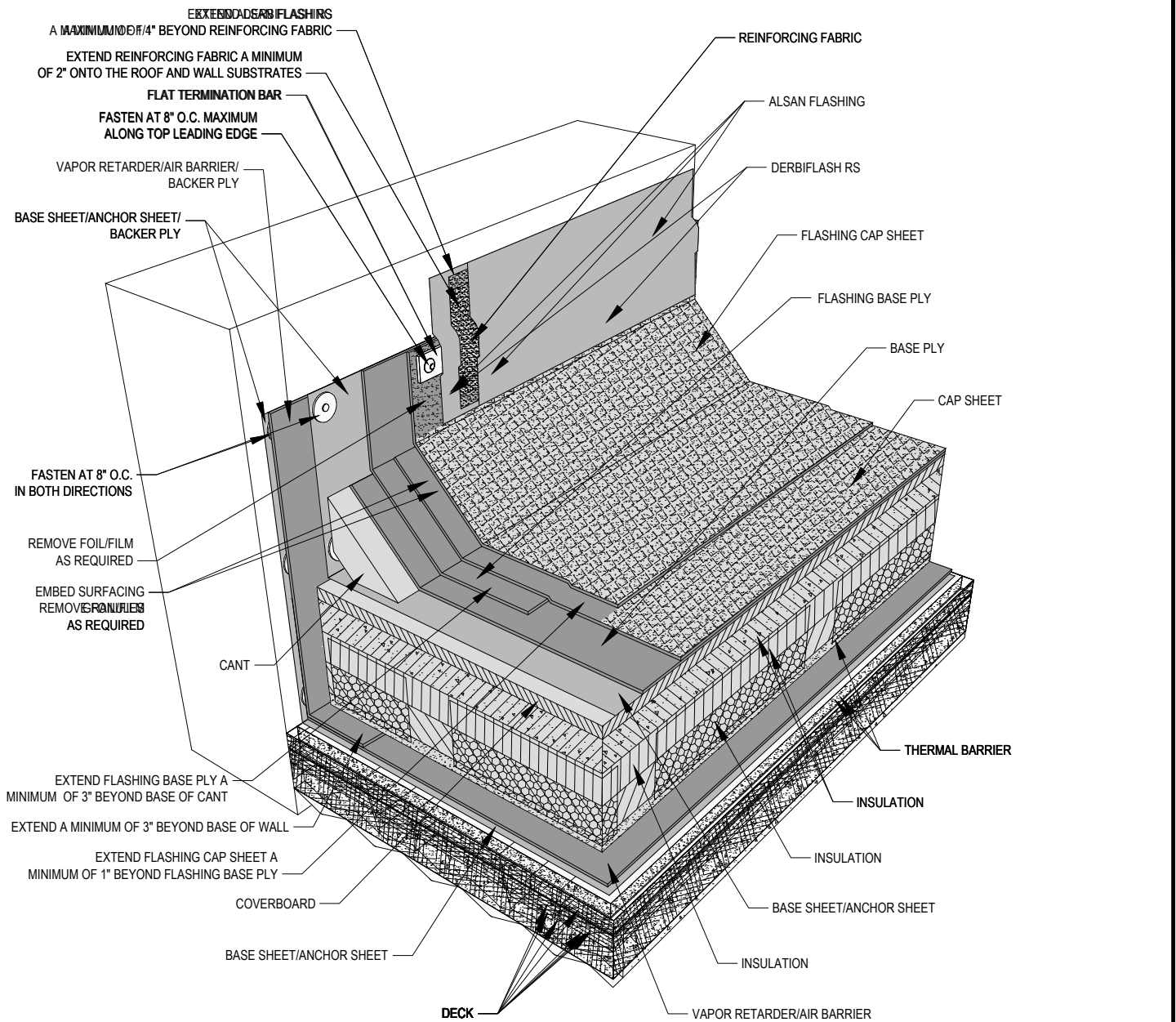

NOTES:

1. PERFORMANCE ROOF SYSTEMS DETAIL DRAWINGS: REFER TO PERFORMANCE ROOF SYSTEMS AND OTHER RELATED PUBLISHED DOCUMENTATION, PRODUCT DATA SHEETS (PDS) AND SAFETY DATA SHEETS (SDS) FOR ADDITIONAL INFORMATION. ALL DETAIL DRAWINGS AND RELATED INSTALLATION GUIDELINES ARE PROVIDED BY PERFORMANCE ROOF SYSTEMS FOR THE SOLE PURPOSE OF ISSUING A PERFORMANCE ROOF SYSTEMS WARRANTY. ACCORDINGLY, THE DETAIL DRAWINGS ARE NOT OFFERED, AND SHOULD NOT BE CONSIDERED, AS A SUBSTITUTE FOR PROFESSIONAL DESIGN SERVICES.
2. HOT WORK: THE CONTRACTOR IS RESPONSIBLE FOR DETERMINING APPROPRIATE CONDITIONS TO UTILIZE HEAT-WELDING EQUIPMENT. REFER TO THE NRCA CERTA RECOMMENDATIONS, LOCAL CODES AND BUILDING OWNER'S REQUIREMENTS FOR HOT WORK OPERATIONS.
3. PRIMER: WHERE NOT SHOWN OR INDICATED ON DETAIL DRAWINGS, REFER TO MATERIAL PRODUCT DATA SHEETS FOR PRIMER APPLICATION REQUIREMENTS
4. FLASHING PLIES MUST EXTEND VERTICALLY A MINIMUM OF 8" FROM ROOF SURFACE. FLASHING PLIES EXTENDING VERTICALLY MORE THAN 24" FROM ROOF SURFACE MUST BE ADHERED AND MECHANICALLY FASTENED ALONG THE TOP LEADING EDGE. REFER TO PUBLISHED DOCUMENTATION.



PERFORMANCE ROOF SYSTEMS
A GORHAM GROUP COMPANY

4800 DR. MARTIN LUTHER KING JR. BLVD.
KANSAS CITY, MO 64130
www.performancerooftsystems.us
Tel: 816.921.0221

PROJECT:	
TITLE:	2 PLY APP MEMBRANE, INSULATED, WALL FLASHING WITH LIQUID APPLIED TERMINATION

DRAWN BY: PRS TECHNICAL SUPPORT, GGALLOWAY		
NO.:	REVISION:	DATE:
DATE: 07.18.2022	DRAWING NUMBER: US.PRS.RM2APP.04.01	
SCALE: NTS		