

DERBIGUM ONE FLASH THRU DRIP EDGE

DESCRIPTION

DERBIGUM ONE Flash Thru Drip Edge is a two-part metal edge assembly specifically designed for use with torch-applied modified bitumen roof systems. Engineered with an interlocking, concealed splice plate designed with a continuous pattern of offset holes on the flange to allow the roofing membranes layers to bond together.

ADVANTAGES

- ▶ Manufactured in 12 ft lengths with pre-punched holes that are slotted to allow for proper thermal movement
- ▶ FM approved for wind uplift protection
- ▶ Easy installation and decreased labor costs
- ▶ Carefully designed and tested to comply with ANSI/SPRI/ES-1 the International Building Code

TYPICAL PROPERTIES

| | |
|---------------------|--|
| Anchor Bar | 12' lengths, extruded 6063-T6 alloy aluminum with pre-slotted holes for fasteners to ensure proper placement |
| Fasteners | # 10 x 2" Stainless steel hexagonal head, with furnished driver bit |
| Face Heights | Available in 2 to 6 inch heights |
| Fascia Cover | Snap-on design, manufactured in 12' lengths, available in the following materials: 24 ga Steel .040" aluminum .050" aluminum .063" aluminum |
| Finishes | - Natural mill-finish aluminum - Pre-coat Kynar® 500 - Premium metallic Kynar - Anodized aluminum – clear, bronze, and black - Custom post-painted Kynar finishes available upon request |

COLORS & FINISHES

Express, standard and premium colors and finishes are available to meet your job requirements. Includes a 30-year Kynar 500 finish warranty on coil-coated standard colors. Custom colors are also available. For the most accurate color representation contact your Performance Roof Systems Sales Representative to request a paint chip.

10 EXPRESS COLORS FOR QUICK SHIPPING

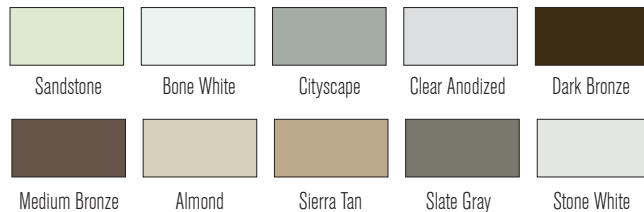

*All colors are available in a mill finish.

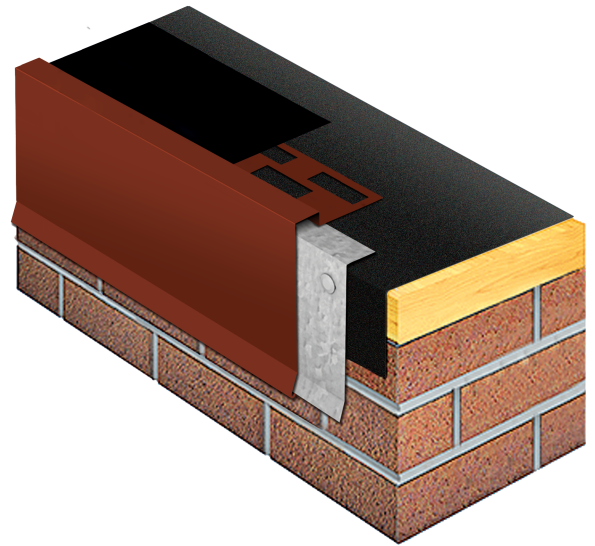

TECHNICAL DRAWINGS

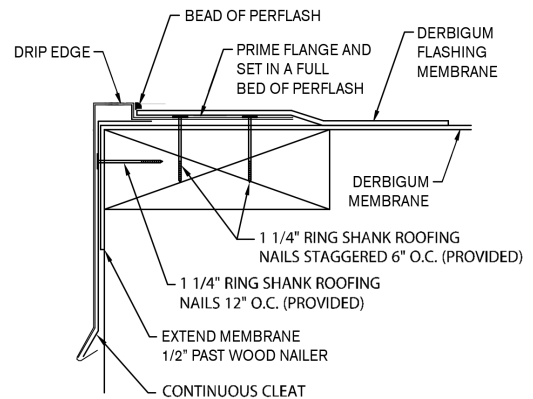

TECHNICAL SERVICES

Engineering and shop drawings are available from the factory. Product samples, detail sheets, color chips and color charts are ready for your submittal package. Long form specifications and CAD details are available on our web site. For personal assistance with questions or submittals, contact Performance Roof Systems Technical Services.