

FLASHING BASE  
PLY(S)  
PRIME  
CONCRETE  
SURFACE

DERBIGUM FLASHING  
MEMBRANE

SET SCUPPER WITH PRIMED  
FLANGES IN PERFLASH  
ADHESIVE NAILED 3" O.C.

STRIP SCUPPER WITH  
DERBIGUM GP FLASHING  
MEMBRANE SET IN PERFLASH  
WITH HEAT WELDED EDGES  
EXTEND TO FRONT EDGE  
OF SCUPPER

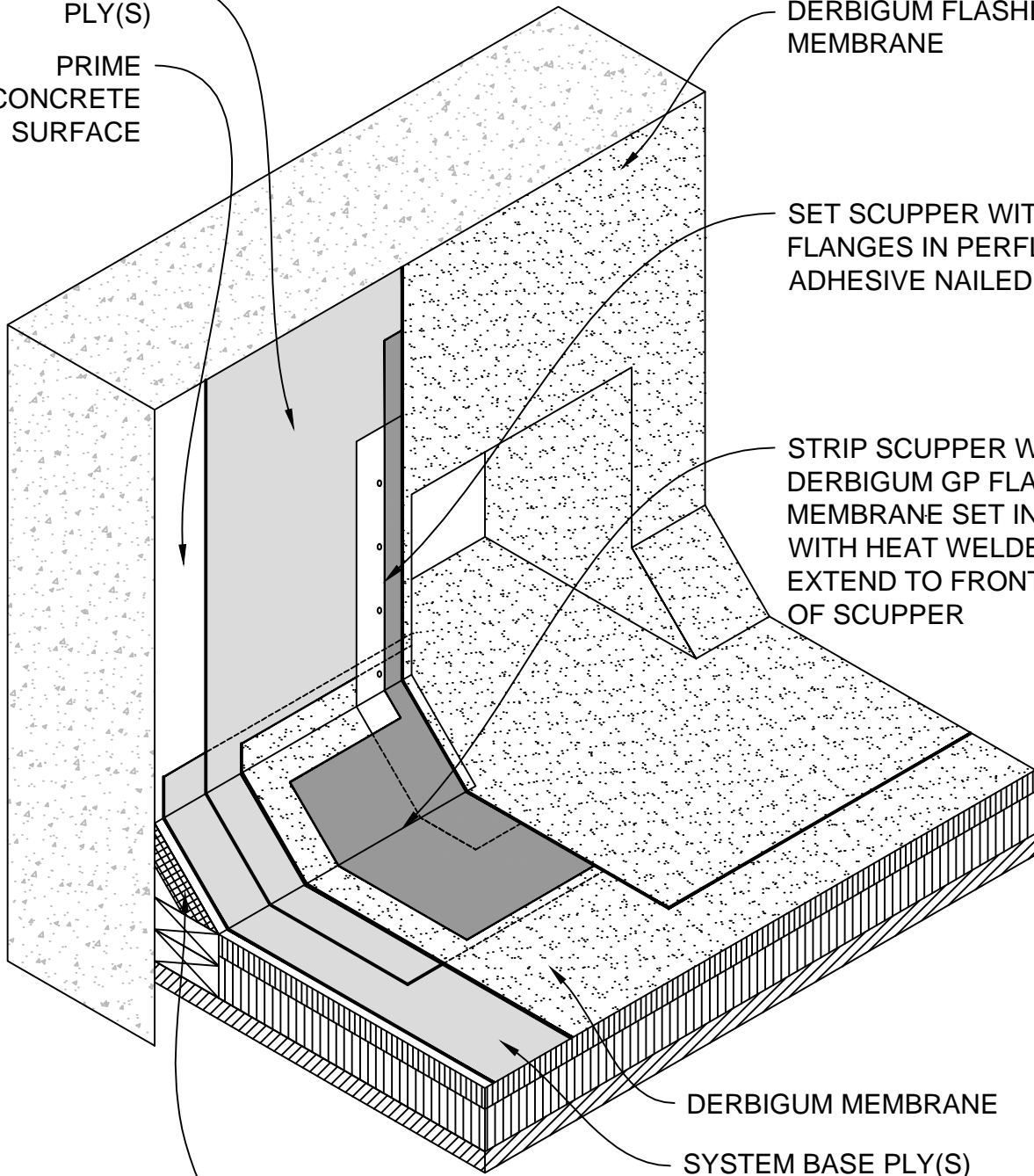

DERBIGUM MEMBRANE

SYSTEM BASE PLY(S)

DERBICANT OR APPROVED  
CANT STRIP SET IN  
PERFLASH ADHESIVE



# P-21 THRU WALL SCUPPER

DERBIGUM AMERICAS, INC. | WWW.DERBIGUM.US

ISSUED  
02/11/16

DETAIL NO.  
P- 21 SD

DRW  
JS

CHK  
LC

REV  
1.0

NOT TO SCALE